

DATE	SUBMISSION
6/21/23	PERMIT SET
DATE	REVISIONS

STUDIO Z DESIGN CONCEPTS, LLC  
 8120 WOODMONT AVENUE SUITE 350  
 BETHESDA, MARYLAND 20814  
 PHONE: 301-951-4391 FAX: 301-951-1913

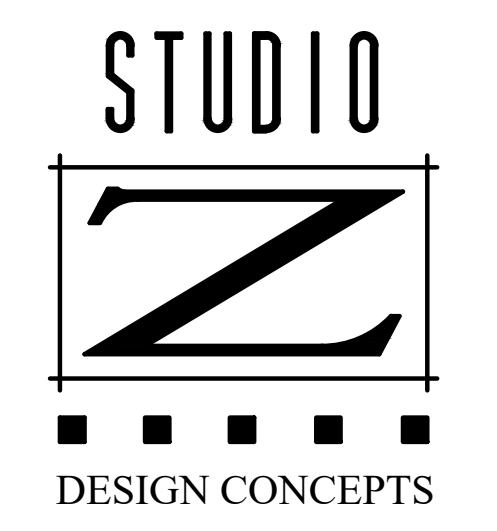

PRIVATE RESIDENCE  
 5305 MCKINLEY STREET  
 BETHESDA, MD 20814

Professional Certification  
 I hereby certify that these documents were prepared or approved by me, and that I am a duly licensed architect under the laws of the State of Maryland License Number: 12214 Exp. Date: 10/20/2023



A102

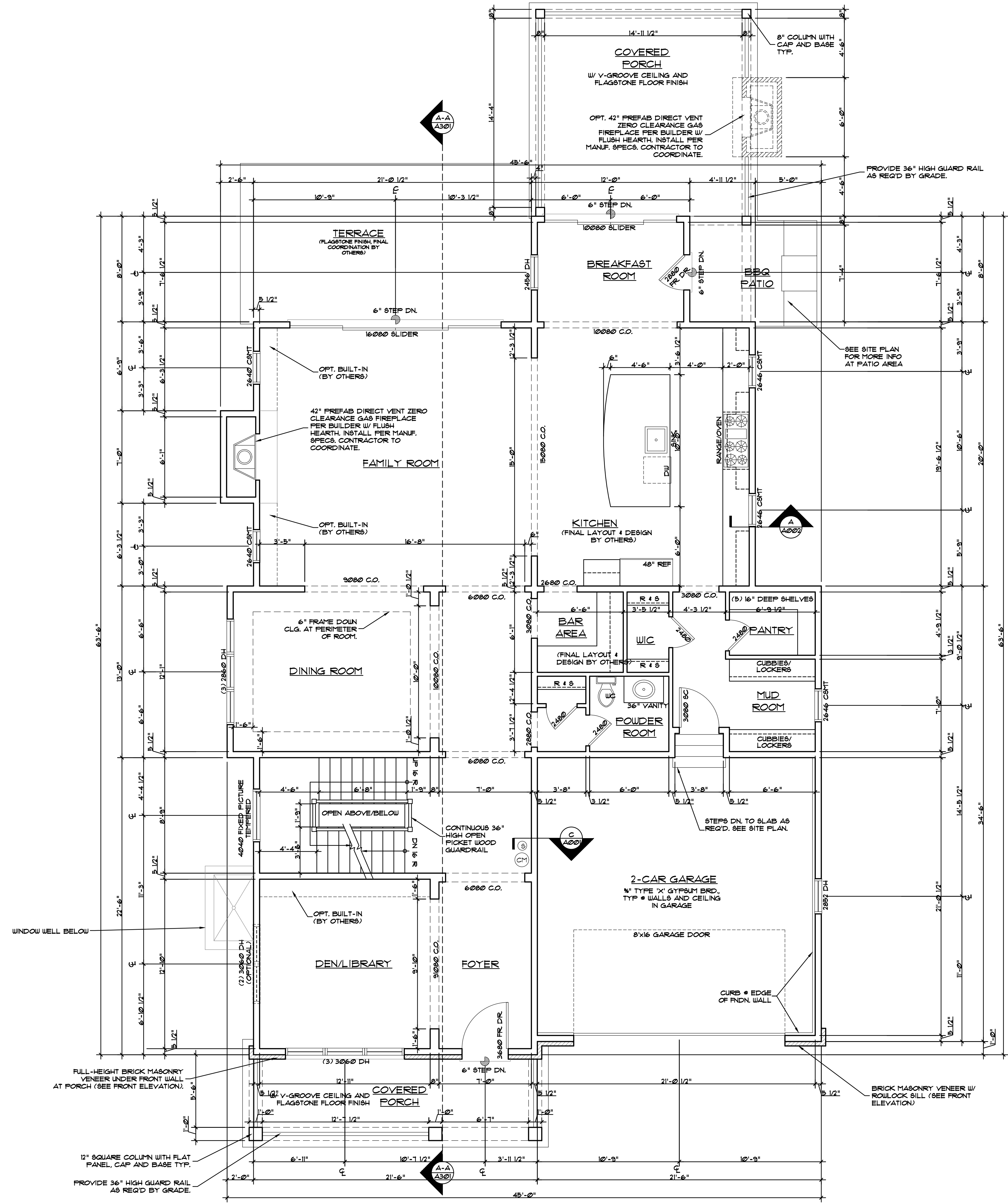

NOTE: ALIGN TOPS OF WINDOWS, BULKHEADS AND CASED OPENINGS TO R.O. OF INTERIOR DOORS, U.O.N.

FIRST FLOOR PLAN

SCALE = 1/4" = 1'-0"  
 1/320 FIN. SF

SOUND BATTS, R-13/16 MIN. AT ALL BATHROOM, LAUNDRY ROOM, AT MECHANICAL CHASES AND SECOND FLOOR DECK BELOW ALL BATHROOMS AND LAUNDRY ROOMS.

FLOOR MATERIAL BREAK



FULL-HEIGHT BRICK MASONRY VENEER UNDER FRONT WALL AT PORCH (SEE FRONT ELEVATION)

12" SQUARE COLUMN WITH FLAT PANEL, CAP AND BASE TYP.

PROVIDE 36" HIGH GUARD RAIL AS REQ'D BY GRADE.

BRICK MASONRY VENEER W/ ROULLOCK SILL (SEE FRONT ELEVATION)

STEPS DN. TO SLAB AS REQ'D. SEE SITE PLAN.

